

TOP VIEW  
SCALE:1/30

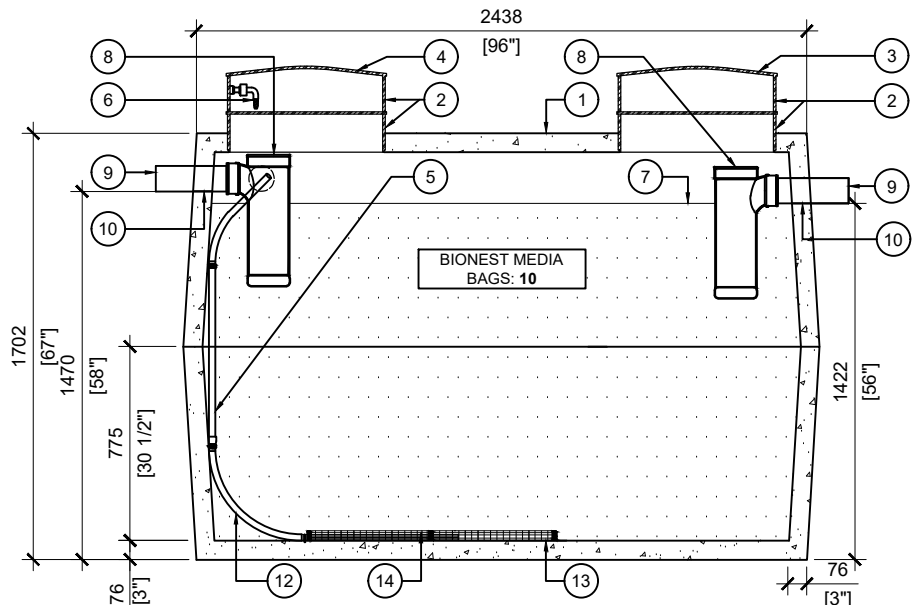

SECTION A  
SCALE:1/30

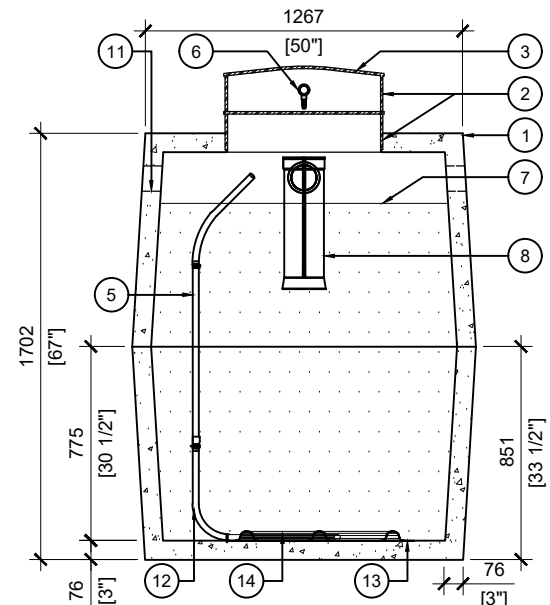

SECTION B  
SCALE:1/30

### BTT-1800-BCP BIONEST REACTOR

| POS. | ITEM #                | DESCRIPTION                                   | QUANTITY |
|------|-----------------------|---|----------|
| 1    | 413567                | BTT-1800-BCP BIONEST REACTOR                  | 1        |
| 2    | 408167                | POLYLOK PLASTIC RISER 24" dia X 6" h          | 4        |
| 3    | 450046                | POLYLOK LID 24" dia - VENTED COVER            | 1        |
| 4    | 450046                | POLYLOK LID 24" dia - DOMED                   | 1        |
| 5    | *SUPPLIED BY BIONEST* | FLEXIBLE AIR DIFFUSER (0.75m)                 | 1        |
| 6    | *SUPPLIED BY BIONEST* | AIR LINE PIPE                                 | 1        |
| 7    | *SUPPLIED BY BIONEST* | BIONEST MEDIA BAG                             | 10       |
| 8    | 408144                | TUF-TITE EF-6" T-BAFFLE                       | 2        |
| 9    | 408038                | 4 x 10" SOLID SEWER PIPE                      | 2        |
| 10   | 112167                | 4" CAST.A.SEAL #452.0450                      | 2        |
| 11   | 112622                | 4" CAST.A.SEAL #452.0450 (CLOSED FACE)        | 2        |
| 12   | *SUPPLIED BY BIONEST* | Ø1-1/2" PVC ELBOW 90° BELL-END TO FACE UPWARD | 1        |
| 13   | *SUPPLIED BY BIONEST* | ABS PLASTIC STRIPS 5" x 24"                   | 2        |
| 14   | *SUPPLIED BY BIONEST* | AIR DIFFUSER CAGE 3.5" x 23"                  | 2        |

#### GENERAL NOTES:

1. UNITS ARE SEALED WITH BUTYL TAPE AT THE JOINTS
2. DELIVERY IS MADE BY CRANE-EQUIPPED TRUCKS
3. EXCAVATION MUST BE READY, SAFE AND ACCESSIBLE FOR UNLOADING FROM THE REAR OF THE TRUCK.
4. MIN OVERHEAD CLEARANCE OF 18FT (5.5 METRES) IS REQUIRED
5. ALL UNITS MUST BE HANDLED WITH PROPER LIFTING EQUIPMENT
6. MAXIMUM BURIAL DEPTH = 1 METRE IN FIRM SOIL AWAY FROM ANY VEHICULAR TRAFFIC



MANUFACTURED:  
BROOKLIN, ON  
1-800-655-3430

CONCRETE: 35MPa at 28 days / 5000PSI  
AIR ENTRAINMENT: 5-8%  
REINFORCEMENT: STEEL TO CSA CAN  
A23.1 / A23.3 G30.18 Fy=400MPa

UNIT WEIGHT: 6,490lbs / 2,943kg  
MEETS CAN/CSA-B66  
BNQ CERTIFIED

DRAWN BY:  
N.CHAN

DATE:  
APR/2020

**BTT-1800-BCP BIONEST REACTOR**  
3600L / 800 IMPERIAL GAL. BIONEST TANK

WORKING CAPACITY: 3723L TO INVERT OF OUTLET  
TOTAL CAPACITY: 4258L TO UNDERSIDE OF CHAMBER LID